

NOTE: EXISTING TREES IN PROPOSED TRANSITION SLOPE SHALL BE REPLANTED BY CONTRACTOR UNDER THE SUPERVISION OF GOLF COURSE OFFICIALS. (20' EAT). SPRINKLER LINE AND HEAD RELOCATION SHALL BE INVESTIGATED BY LANDSCAPE ARCHITECT PRIOR TO BIDDING.

GRADING LEGEND

- PROPOSED A.C. PAVEMENT
- PROPOSED CONCRETE
- PAVEMENT TRANSITION AREA
- EXISTING CONTOUR LINES
- FINISH GRADE CONTOUR
- RETAINING WALL
- F.F. FINISH FLOOR ELEVATION
- GRADE BREAK
- LOT NUMBER
- FLOWLINE ELEVATION
- ELEV. ● GRADE BREAK
- ELEV. ● FINISHED GRADE
- ELEV. ● HIGH PT./LOW PT.
- ELEV. ● TOP OF CURB
- DRAINAGE SWALE W/FLOW DIRECTION & GRADE INDICATED

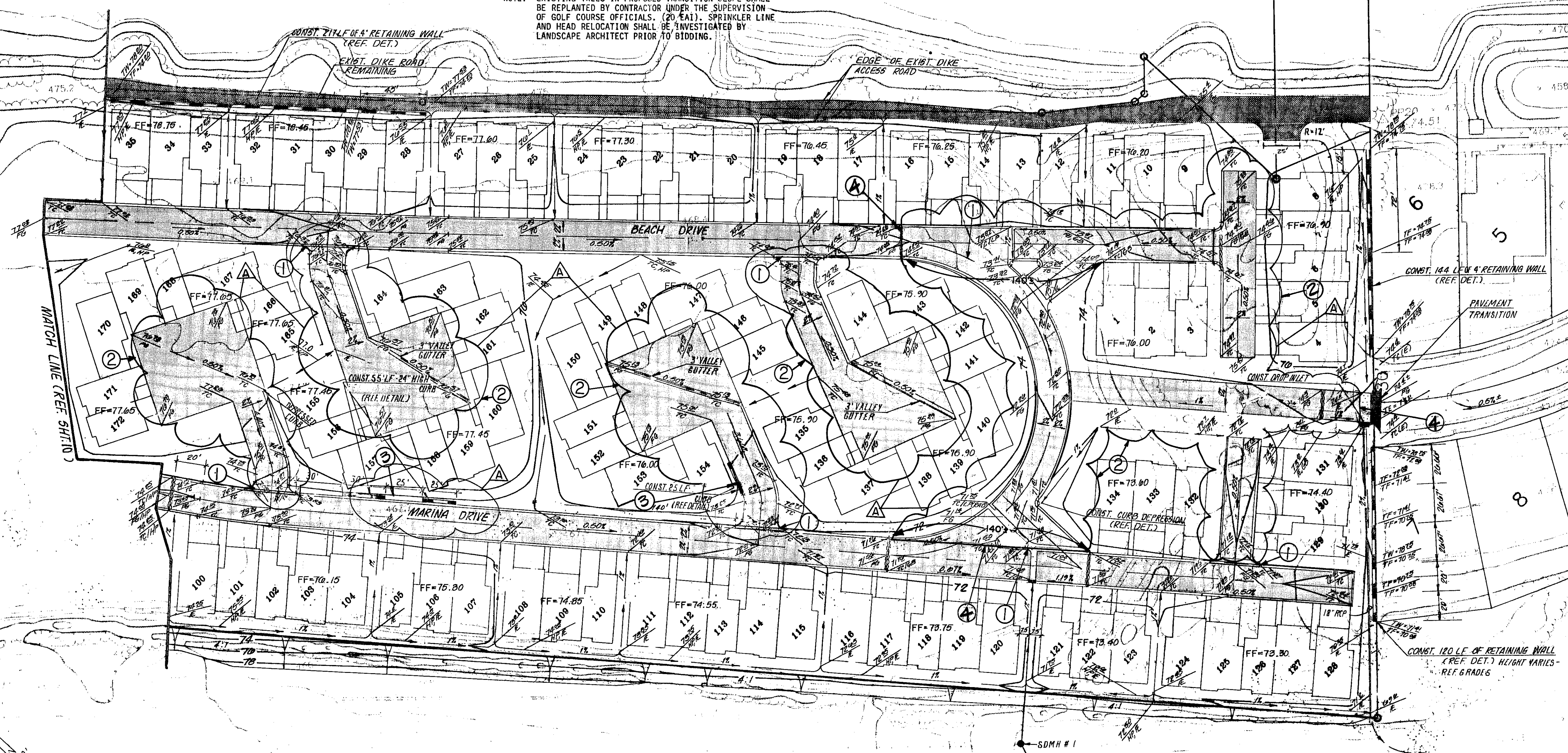

CONSTRUCTION NOTES

- 1 REMOVE EXISTING VALLEY GUTTER
REPLACE WITH CURB & GUTTER
- 2 REMOVE ALL EXISTING SURFACE IMPROVEMENTS, INCLUDING CURB, VALLEY GUTTER & A.C.
- 3 REMOVE EXISTING 24\"/>

NOTE: DIKE ROAD MUST HAVE 10 FT. MIN. TOP WIDTH.

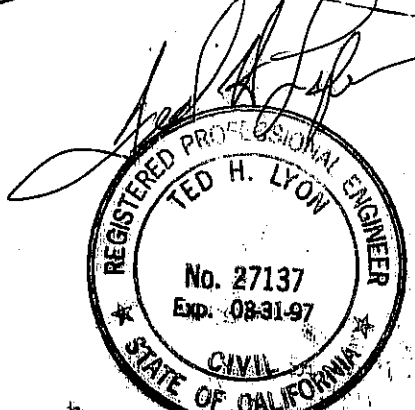
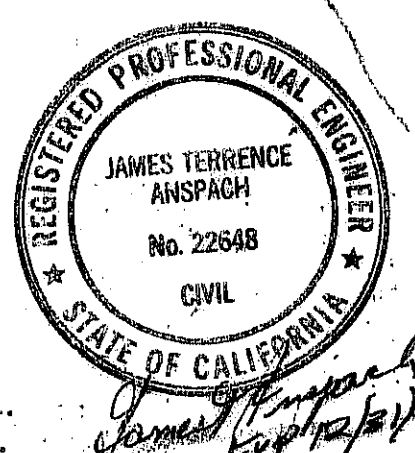

SUMMIT ENGINEERING CORPORATION
 CONSULTING ENGINEERS AND SURVEYORS
 115 S. MAIN AVENUE, SUITE 420, LAS VEGAS, NEVADA 89101
 PHONE: (702) 734-1800 FAX: (702) 734-0622

DESIGNED BY: A.S.M.
 DRAWN BY: K.K.A.
 CHECKED BY: J.T.A.
 DATE: JULY 1994

EXISTING GRADING PLAN-(REMOVAL)
 PORTOBELLO TOWNHOME DEVELOPMENT
 MAHALA DEVELOPMENT CORPORATION
 NEEDLES, SAN BERNARDINO, CALIFORNIA

REV.	DATE	DESCRIPTION	BY	APP'D
A	9/19/94	REMOVAL OF EXISTING FACILITIES	JSM	

SCALE: 1" = 40'
 SHEET 6 OF 15
 JOB NO. 708651

DRG K-2